

Submersible Pump

Installation and Operating Instructions

Models

- **Multi Purpose**

**RS-750, JS-750, JS-1500, JS-2200, JST-22, JST-37,
JST-55, JST-75, RST-08, JST-08, RST-15, JST-15**

- **Sewage Pump**

**JS-750S, JS-1500S, JS-2200S, JS-750SV, JS-1500SV,
JS-2200SV, JST-8S, JST-15S, JST-22S, JST-37S, JST-55S,
JST-75S, JST-8SV, JST-15SV, JST-22SV, JST-37SV**

- **Shredder Pump**

**JS-750SK, JS-1500SK, JS-2200SK, JST-8SK, JST-15SK,
JST-22SK, JST-37SK, JST-55SK, JST-75SK**

Installation & Operating Instructions

Thank you for purchasing one of our pumps.

This pump carries a 12 month warranty. Should a fault develop that is due to either faulty materials or a fault in manufacture, the pump will be repaired or replaced free of charge.

Applications for models: RS-750, JS-750, JS-1500, JS-2200, JST-22, JST-37, JST-55, JST-75, RST-08, JST-08, RST-15, JST-15

Range of Submersible Sump Pumps are suited for the De-watering (or recirculating) applications.

They are extremely quiet in operation which makes them ideal for applications within residential areas for sullage pits, pool emptying, waterfalls and general drainage.

Other ideal applications are:

Lift Wells Car Park Sumps Basements Cable Pits, etc.

Special applications for:

Sewage pump models: JS-750S, JS-1500S, JS-2200S, JS-750SV, JS-1500SV, JS-2200SV, JST-8S, JST-15S, JST-22S, JST-37S, JST-55S, JST-75S, JST-8SV, JST-15SV, JST-22SV, JST-37SV

Shredder pump models: JS-750SK, JS-1500SK, JS-2200SK, JST-8SK, JST-15SK, JST-22SK, JST-37SK, JST-55SK, JST-75SK

- Sewage in tannery and farm.
- Sewage light slurry and factory waste.
- Sludge carry off in water treatment.
- All sanitary applications, sewage and waste water duties.

This Submersible Sump Pump has been factory checked prior to delivery ; however, please check for any damage during transport.

Sales and service is available from Pumps or Authorised Dealers.

Do Not

- Lift the pump by the motor lead
- Run the pump dry
- Attempt electrical repairs
- Run the pump with the motor fully exposed for long periods
- Install the pump on soft or loose ground

Details (CHECK NAME PLATE)

Installation

The Sump Pump is completely submersible and should be placed on a solid flat surface (if not available sit the pump on timber or house bricks) in the vertical position.

Always use the biggest diameter hose possible, a better flow is obtained and the pump will work "easier". All hose can be obtained from our factory if required.

15TH EDITION IEE REGULATIONS. ALWAYS USE A POWER BREAKER WITH OUT SIDE ELECTRICITY. IF IN DOUBT CONSULT AN APPROVED NICEIC ELECTRICIAN.

- With simple cleaning and regular examination this pump should give many years of service.

Fault Checks

(A) Pump will not start:

- Power switched ON
- Blown fuse (consult an electrician)
- If *extension lead fitted check connection
- Impeller jammed
- Thermal cut out switch has not reset (5 minutes)
- If pump does not start from new then the seal has possibly stuck due to the length of time it has been standing since it was manufactured. In this case, remove bottom strainer and turn the impeller nut clockwise with a pair of pliers, this will release the initial friction on the seal and once the power is connected will allow the pump to work.

***If fitting an extension lead a QUALIFIED ELECTRICIAN should be consulted to ensure correct rating is provided.**

(B) Pump will start but does not pump:

- Insufficient liquid in sump
- Strainer blocked
- Impeller blocked
- Impeller damaged
- Entrained air present
- Excessive back pressure

(C) Pump will not stop:

- Must be switched **off at the power supply**

Singe Phase 220V or 240V

RS-750

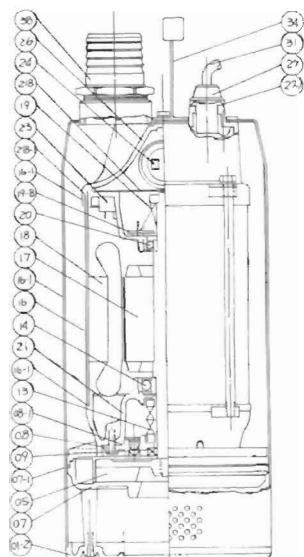

JS-750

JS-1500

JS-2200

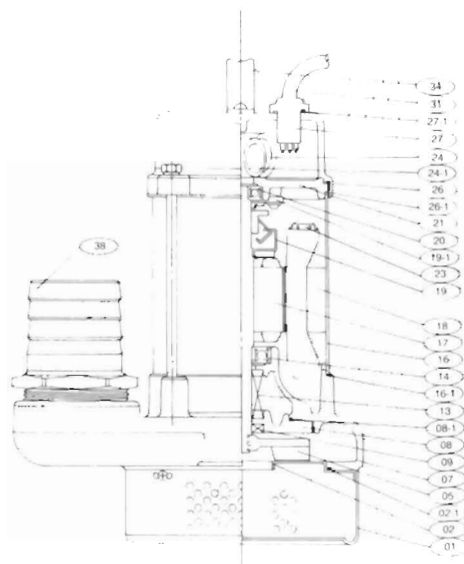

JS-750S ,SK,SV

JS-1500S,SK,SV

JS-2200S,SK,SV

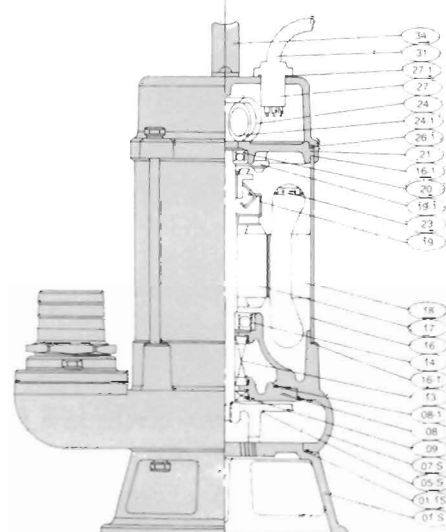

3 Phase 220V ~ 440V

RST-8

RST-15

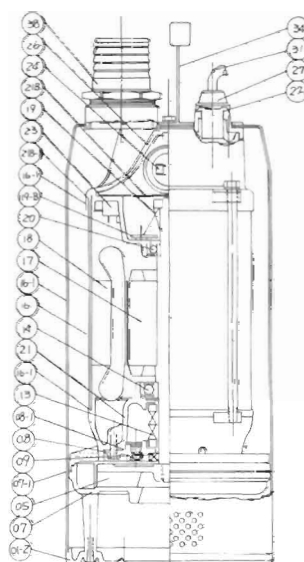

JST-08

JST-15

JST-22

JST-37

JST-55

JST-75

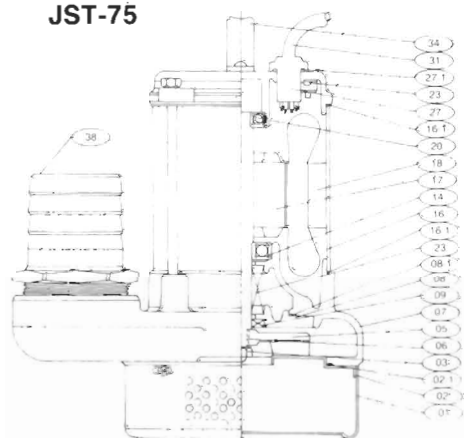

JST8-S,SK,SV

JST-15-S,SK,SV

JST-22,S,SK,SV

JST-37,S,SK,SV

JST-55,S,SK

JST-75,S,SK

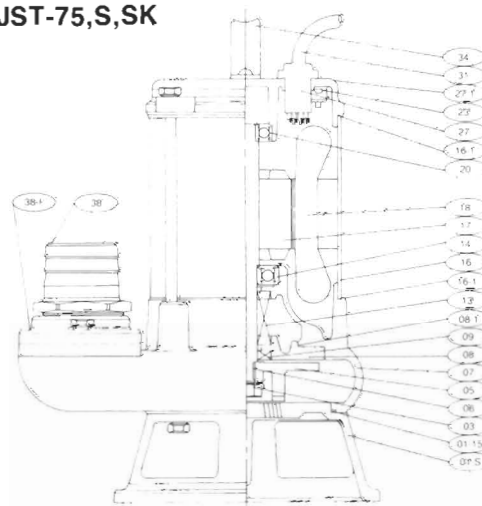

Item Description

01	Strainer	14	Bearing (Lower)	24	Condensor (Run)
02	Suction Cover	16	Motor Case	24-A	Condensor (Start)
02-1	Suction Cover Packing	16-1	O-Ring	26-A	Upper Cover
03	Nut (Of Impeller)	17	Rotor/Shaft	26-1	O-Ring
05	Impeller	18	Stator Coil	27	Cable Gland
07	Pump Housing	19	Governor Switch	27-1	O-Ring
08	Cover Of Oil Chamber	19-A	Governor Switch Plate	31	Cabel
08-1	O-Ring	20	Bearing (Upper)	34	Handle
09	Lip Seal	21	Inside Cover	38	Discharge Outlet
13	Mechanical Seal	23	Overload Protector		